

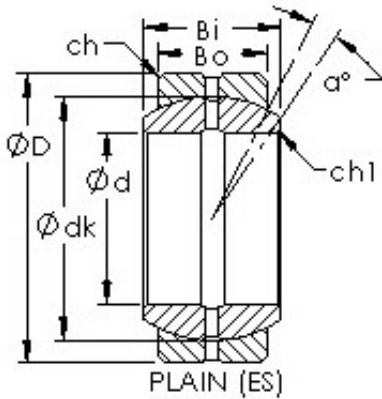

BEARING FORGE OF AMERICA CORP.



AST GEG160ES plain bearings

Bearing No. GEG160ES

Bore Diameter	160 mm
Outer Diameter	260 mm
Bearing Type	plain
Bore Dia (d)	160.0000
Outer Dia (D)	260.0000
Outer Width (Bo)	80.0000
Inner Width (Bi)	135.0000
Dynamic Load Rating (Cr)	1,530,000
Static Load Rating (Cor)	7,650,000
Max. shaft corner radius, or 45 deg. chamfer (ch1)	1.100
Max. housing corner radius, or 45 deg. chamfer (ch)	1.100
Spherical Diameter (dk or Dk)	225.000
Mis-alignment Angle (a deg.)	16
Weight (g)	24,800.00
Material	52100 Chrome steel, or equivalent

GEG160ES Bearing 2D drawings and 3D CAD models