

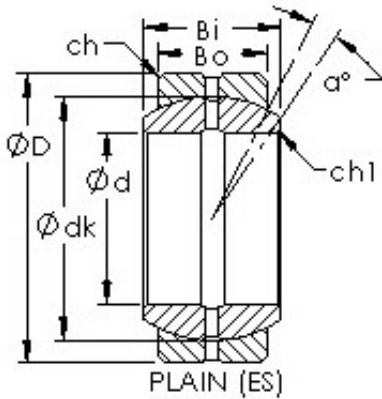

# BEARING FORGE OF AMERICA CORP.



## AST GE240ES plain bearings

Bearing No. GE240ES

Bore Diameter	240 mm
Outer Diameter	340 mm
Bearing Type	plain
Bore Dia (d)	240.0000
Outer Dia (D)	340.0000
Outer Width (Bo)	100.0000
Inner Width (Bi)	140.0000
Dynamic Load Rating (Cr)	2,550,000
Static Load Rating (Cor)	12,700,000
Max. shaft corner radius, or 45 deg. chamfer (ch1)	1.100
Max. housing corner radius, or 45 deg. chamfer (ch)	1.100
Spherical Diameter (dk or Dk)	300.000
Mis-alignment Angle (a deg.)	8
Weight (g)	39,700.00
Material	52100 Chrome steel, or equivalent

GE240ES Bearing 2D drawings and 3D CAD models