

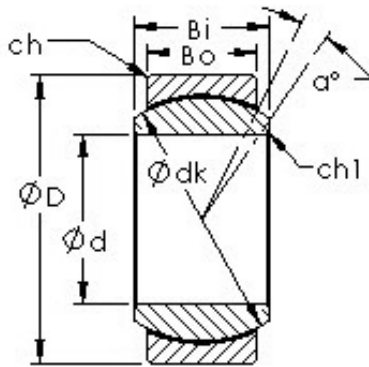

BEARING FORGE OF AMERICA CORP.



AST GEBJ14C plain bearings

Bearing No. GEBJ14C

Bore Diameter	14 mm
Outer Diameter	28 mm
Bearing Type	wide
Bore Dia (d)	14.0000
Outer Dia (D)	28.0000
Outer Width (Bo)	13.5000
Inner Width (Bi)	19.0000
Dynamic Load Rating (Cr)	31,000
Static Load Rating (Cor)	77,000
Max. shaft corner radius, or 45 deg. chamfer (ch1)	0.300
Max. housing corner radius, or 45 deg. chamfer (ch)	0.600
Spherical Diameter (dk or Dk)	25.400
Mis-alignment Angle (a deg.)	15
Weight (g)	55.00
Material - Outer Ring - Carbon steel, Inner ring	52100 Chrome steel, or equivalent

GEBJ14C Bearing 2D drawings and 3D CAD models