

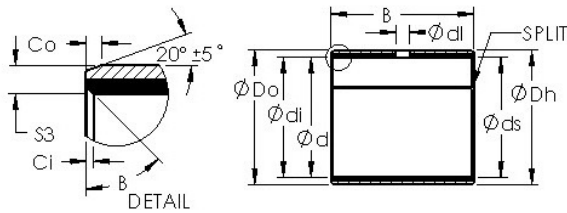

# BEARING FORGE OF AMERICA CORP.



## AST AST40 1410 plain bearings

Bearing No. AST40 1410

Bore Diameter	14 mm
Outer Diameter	16 mm
Bearing Type	straight
Shaft Dia., Nominal (d)	14.0000
Shaft Size (ds) - 14 -0.016 / -0.034	14 0.016 / 0.034
Housing Bore Dia. (Dh)	16 +0.018 / +0
Bearing Outside Diameter, Nominal(Do)	16.000
Bearing Outside Diameter Tolerance (Do tol.)	16.065 / 16.03
Bearing Bore after Mounting (di)	14.058 / 13.99
Average Clearance (Cd)	0.0490
Wall Thickness (S3)	1.005
Bearing Length, Nominal (B)	10.000
Bearing Length Tolerance (B tol.) - +0 / -0.30	+0 / 0.30
OD Chamfer Length (Co)	0.600
ID Chamfer Angle (B deg.)	30
ID Chamfer Length (Ci)	0.300
Material	Steel shell with PTFE / Polymer Fiber lining

AST40 1410 Bearing 2D drawings and 3D CAD models