

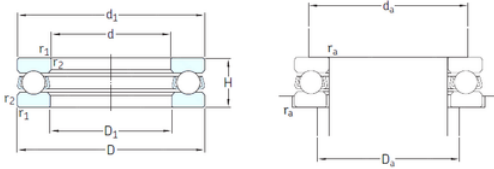

# BEARING FORGE OF AMERICA CORP.



## skf 51211 bearing

Bearing No. 51211

51211 Bearing 2D drawings and 3D CAD models

Size	55x90x25 mm
Bore Diameter	55 mm
Outer Diameter	90 mm
Width	25 mm
d	55 mm
D	90 mm
H	25 mm
d1	90 mm
r1 min.	1 mm
r2 min.	1 mm
D1	57 mm
da min.	76 mm
Da max.	69 mm
ra max.	1 mm
Weight	0,59 Kg
Basic dynamic load rating (C)	58,5 kN
Basic static load rating (C0)	134 kN
Fatigue load limit (Pu)	4,9
Reference speed	2800 r/min
Limiting speed	4000 r/min
Category	Thrust Ball Bearing
Inventory	0.0
Manufacturer Name	SKF
Minimum Buy Quantity	N/A
Weight / Kilogram	0.601
EAN	7316577058485



## BEARING FORGE OF AMERICA CORP.

Product Group	B00308
Rolling Element	Ball Bearing
Thrust Bearing	Yes
Single or Double Direction	Single Direction
Banded	No
Cage Material	Steel
Precision Class	ABEC 1   ISO P0
Component Description	Roller Assembly Plus Raceways
Other Features	Single Row
Long Description	55MM Bore 1; 57MM Bore 2; 90MM Outside Diameter; 25MM Height; Ball Bearing; Single Direction; Not Banded; Steel Cage; ABEC 1   ISO P0 Precision
Inch - Metric	Metric
Category	Thrust Ball Bearings
UNSPSC	31171507
Harmonized Tariff Code	8482.10.50.08
Noun	Bearing
Keyword String	Ball Thrust
Manufacturer URL	<a href="http://www.skf.com">http://www.skf.com</a>
Manufacturer Item Number	51211
Weight / LBS	1.323
Overall Height with Aligning Washer	0 Inch   0 Millimeter
Bore 1	2.165 Inch   55 Millimeter
Height	0.984 Inch   25 Millimeter
Outside Diameter	3.543 Inch   90 Millimeter
Bore 2	2.244 Inch   57 Millimeter
bore diameter:	55 mm
static load capacity:	134 kN
outside diameter:	90 mm



## BEARING FORGE OF AMERICA CORP.

dynamic load capacity:	58.5 kN
overall width:	25 mm
maximum rpm:	4000 RPM
thrust bearing type:	Single-Direction
cage material:	Steel
outside diameter design:	Straight
fillet radius:	1 mm
separable or banded:	Separable
series:	512
precision rating:	ABEC 1 (ISO Class Normal)
$d_1$	90 mm
$D_1$	57 mm
$r_{1,2}$ min.	1 mm
$d_a$ min.	76 mm
$D_a$ max.	69 mm
$r_a$ max.	1 mm
Basic dynamic load rating C	58.5 kN
Basic static load rating $C_0$	134 kN
Fatigue load limit $P_u$	4.9 kN
Minimum load factor A	0.11
Mass bearing (including seat washer where applicable)	0.59 kg