

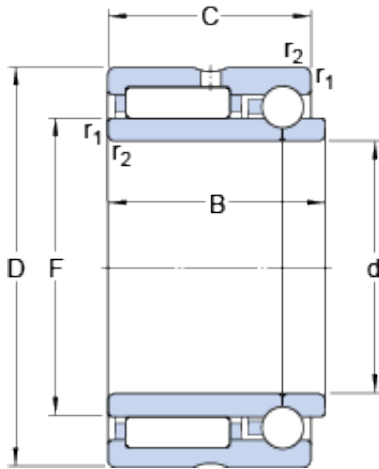

BEARING FORGE OF AMERICA CORP.



20 mm x 37 mm x 25 mm skf nkib 5904 bearing

Bearing No. nkib 5904

nkib 5904 Bearing 2D drawings and 3D CAD models

| | |
|---|-------------|
| Size | 37x20x25 mm |
| Bore Diameter | 37 mm |
| Outer Diameter | 20 mm |
| Width | 25 mm |
| d | 20 mm |
| D | 37 mm |
| B | 25 mm |
| C | 23 mm |
| F | 25 mm |
| r _{1,2} - min. | 0.3 mm |
| d _a - min. | 22 mm |
| D _a - max. | 35 mm |
| r _a - max. | 0.3 mm |
| Basic dynamic load rating, radial direction - C | 21.6 kN |
| Basic static load rating, radial direction - C ₀ | 28 kN |
| Basic dynamic load rating, axial direction - C | 3.8 kN |
| Basic static load rating, axial direction - C ₀ | 4.2 kN |
| Fatigue load limit, radial direction - P _u | 3.4 kN |
| Fatigue load limit, axial direction - P _u | 0.176 kN |
| Reference speed | 15000 r/min |
| Limiting speed | 17000 r/min |
| | |



BEARING FORGE OF AMERICA CORP.

| Category | Roller Bearings |
|--|-----------------|
| Inventory | 0.0 |
| Manufacturer Name | SKF |
| Minimum Buy Quantity | N/A |
| Weight / Kilogram | 0.115 |
| EAN | 7316577710062 |
| Product Group | B04144 |
| $r_{1,2}$ min. | 0.3 mm |
| d_a min. | 22 mm |
| D_a max. | 35 mm |
| r_a max. | 0.3 mm |
| Basic dynamic load rating, radial direction C | 21.6 kN |
| Basic static load rating, radial direction C_0 | 28 kN |
| Basic dynamic load rating, axial direction C | 3.79 kN |
| Basic static load rating, axial direction C_0 | 4.21 kN |
| Fatigue load limit, radial direction P_u | 3.35 kN |
| Fatigue load limit, axial direction P_u | 0.176 kN |
| Mass bearing | 0.11 kg |